

ML6420A / ML7420A Electric Linear Actuator

Spare Parts

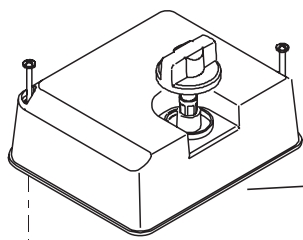

Description	Honeywell Part-No.	ML 6420				ML 7420							
		A3007	A3015	A3023	A3072	A3006	A3014	A3071	A6009	A6017	A6025	A6033	A6041
Cover	43193811-001	•	•	•		•	•		•	•		•	•
	43193712-001				•			•			•		
Motor Assy.	43193813-001		•										
	43193813-002	•				•	•		•	•		•	•
	43193813-005			•			•			•			•
Circuit-Board Assy.	43193808-004*						•						
	43193808-005*							•					

* ⚠ Wiring needs to be changed before datecode 9901 (week 1 in 1999)

